

# Spring break device

25449 25549 299540 299541

## Index

1. Overview .....	2
2. Tools .....	3
3. Operation .....	3
4. Scope of application .....	3
5. Installation .....	4
6. Optional extras .....	8
7. TÜV approval .....	10
8. Replacing (after a broken spring) .....	11
9. Maintenance .....	11
10. Supplier .....	11
11. Terms and conditions of supply .....	11

## 1. Overview

	Description
<b>A</b>	Shaft
<b>B</b>	Set screws (M8 x 10)
<b>C</b>	Blocking wheel
<b>D</b>	Blocking plate
<b>E</b>	Bolt (M10 x 30)
<b>F</b>	Safety lock
<b>G</b>	Blocking pawl
<b>H</b>	Safety spring
<b>I</b>	Base plate
<b>J</b>	Bearing
<b>K</b>	Spacer
<b>L</b>	Spring plug
<b>M</b>	Nut (M10)
<b>N</b>	Torsion spring
<b>O</b>	Micro switch

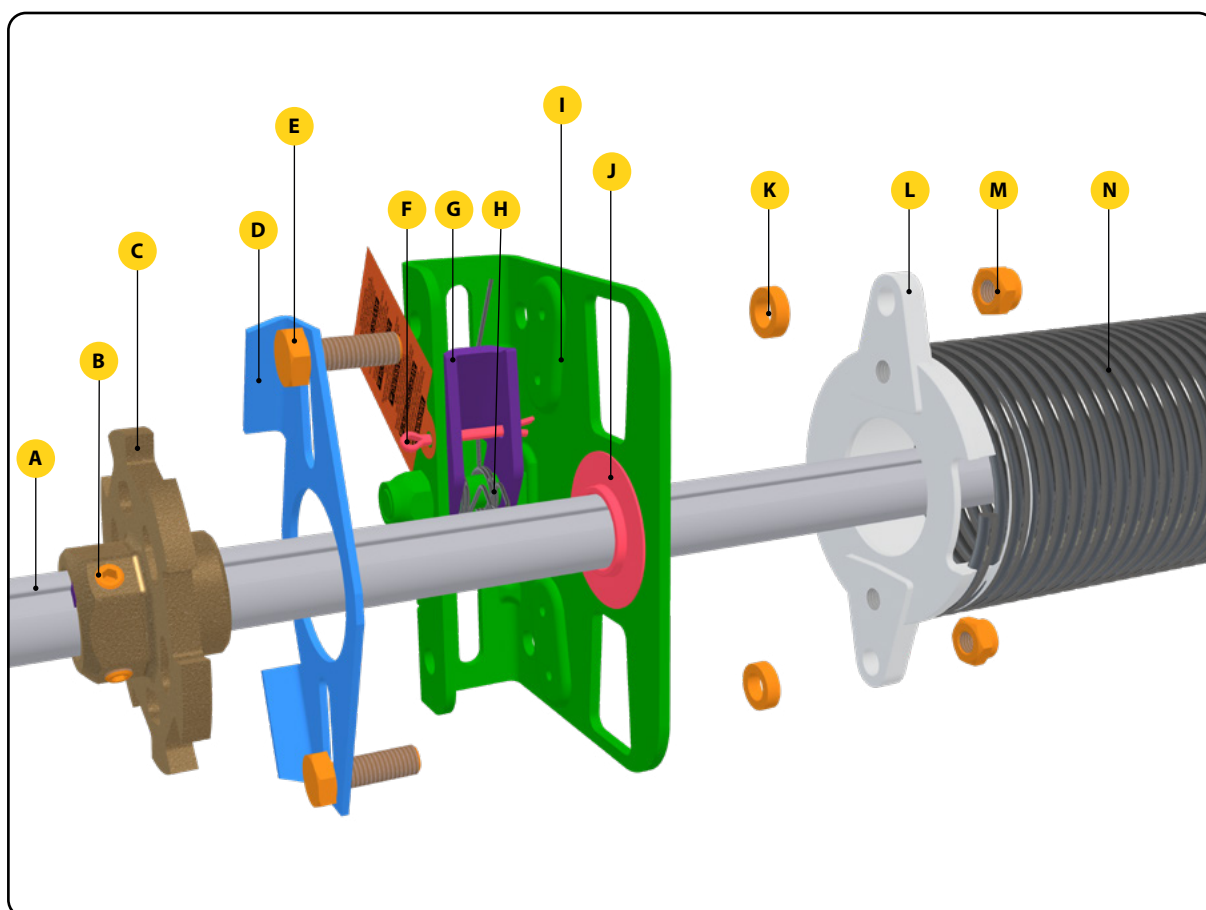

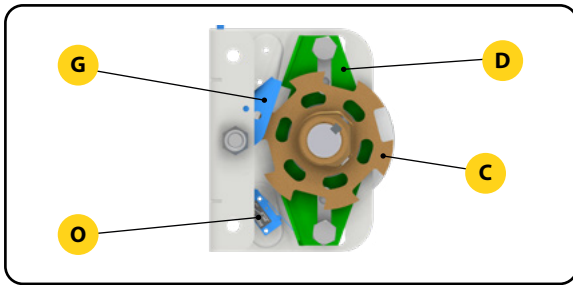

## 2. Tools

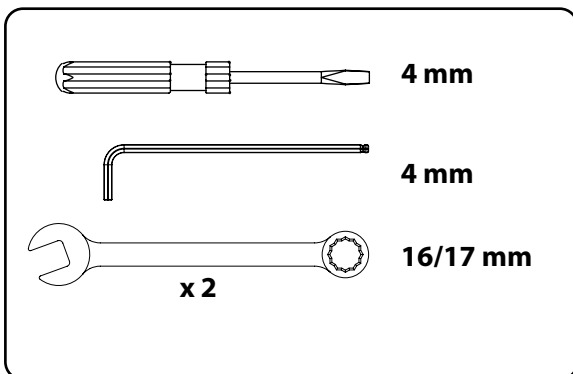

## 3. Operation

### IMPORTANT:

Tensioned springs carry a high tension. Therefore always be very careful, especially when adjusting. Always use well maintained tensioning rods (12025) of the right size. Ensure that the mounting place for the spring break protection is structurally strong enough to attach the spring break protection and to absorb the force of any cable break!

Persons and animals can be hit by falling parts from the wall or ceiling which can lead to severe injuries or even death!

- Check the stability of the mounting wall.
- Only use approved fasteners to mount the spring break device.

When the torsion spring (N) is tensioned, the blocking plate (D) turns slightly. This will cause the bent tab of the blocking plate (D) to block the blocking pawl (G). The blocking wheel (C) fitted to the shaft with key can now rotate freely.

When a spring breaks, spring tension is removed, so the blocking plate (D) can rotate back. The force of the spring (H) will cause the blocking pawl (G) to push the blocking plate (D) away and engage with the teeth of the blocking wheel (C), preventing the door panel from falling. The blocking plate (D) being rotated back now triggers the micro switch (O), stopping the electric drive.

## 4. Scope of application

Spring break protection devices 25449 and 25549 are used in industrial sectional doors that are operated either manually, using a chain or electrically. They can be used within a temperature range of -20 °C to +50 °C.

- Type 25449 and 299540/299541 are used in sectional doors with a 1" (25.4mm) shaft with key way.
- Type 25549 is used in sectional doors with a 1 ¼" (31.75mm) shaft with key way.
- Spring heads to be fitted: 50mm spring head up to 152mm spring head

When using a certain cable drum, the **minimum number** of spring break protection devices per door may be **calculated as follows**:

$$\frac{M_{\max}}{0,5 \times d \times g} = D$$

M <sub>max</sub>	Maximum torque (210 Nm)
d	Drum diameter (m)
g	Gravity (9,81 m/s <sup>2</sup> )
D	Door panel weight (kg)

- D is the weight that determines if one or more spring break devices are needed.
- The maximum torque per spring break protection is 210 Nm.
- The drum diameter is measured at the unwind point of the cable when the door is closed!
- One spring break protection is installed for each torsion spring.

**⚠ The maximum specified weight for the cable drum may never be exceeded!**

### Example:

Cable drum 110020 (M134-5500) has a diameter of **138,2 mm**

$$\frac{210}{0,5 \times 0,1382 \times 9,81} = 303,9$$

So for cable drum 110020:

D	# spring break devices
≤ 303,9	1
> 303,9	≥ 2

## 5. Installation

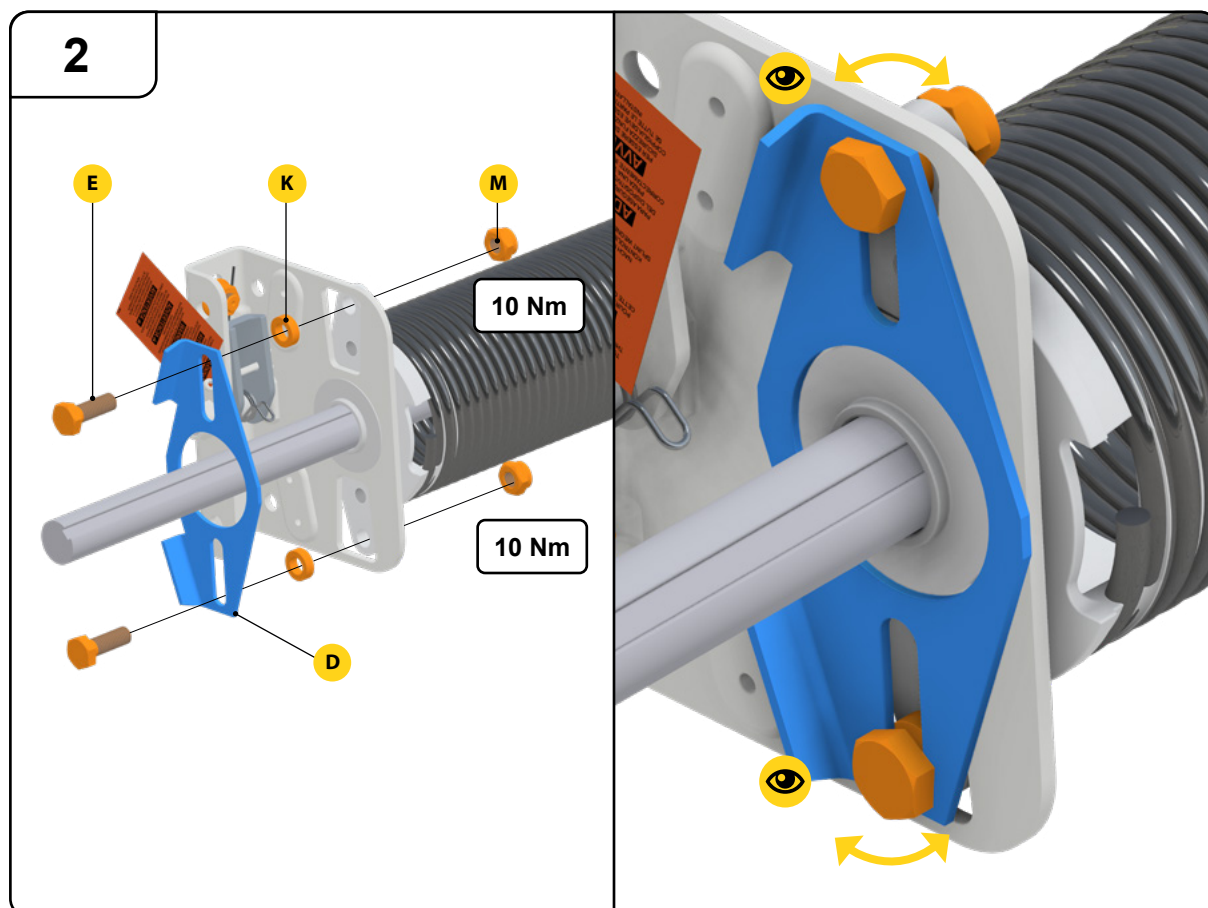
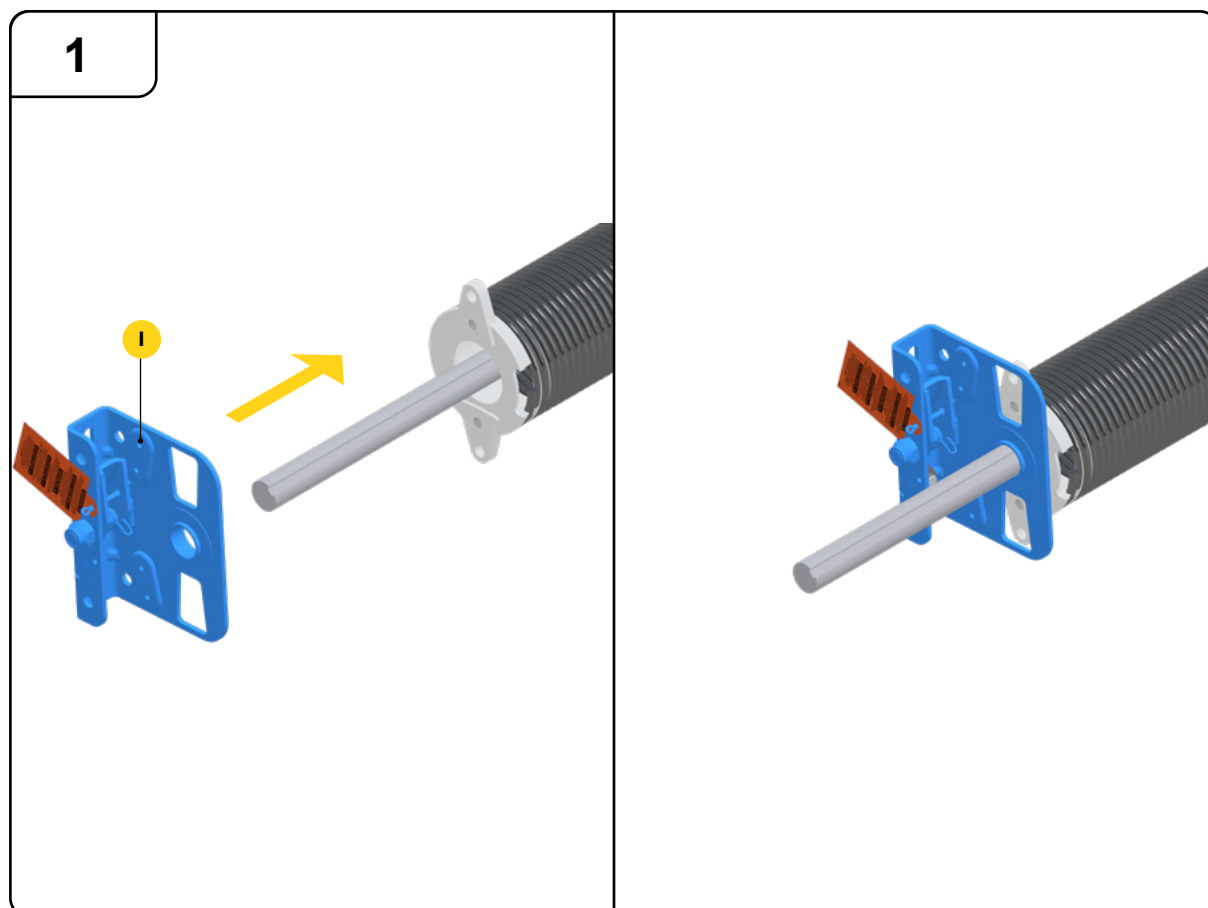



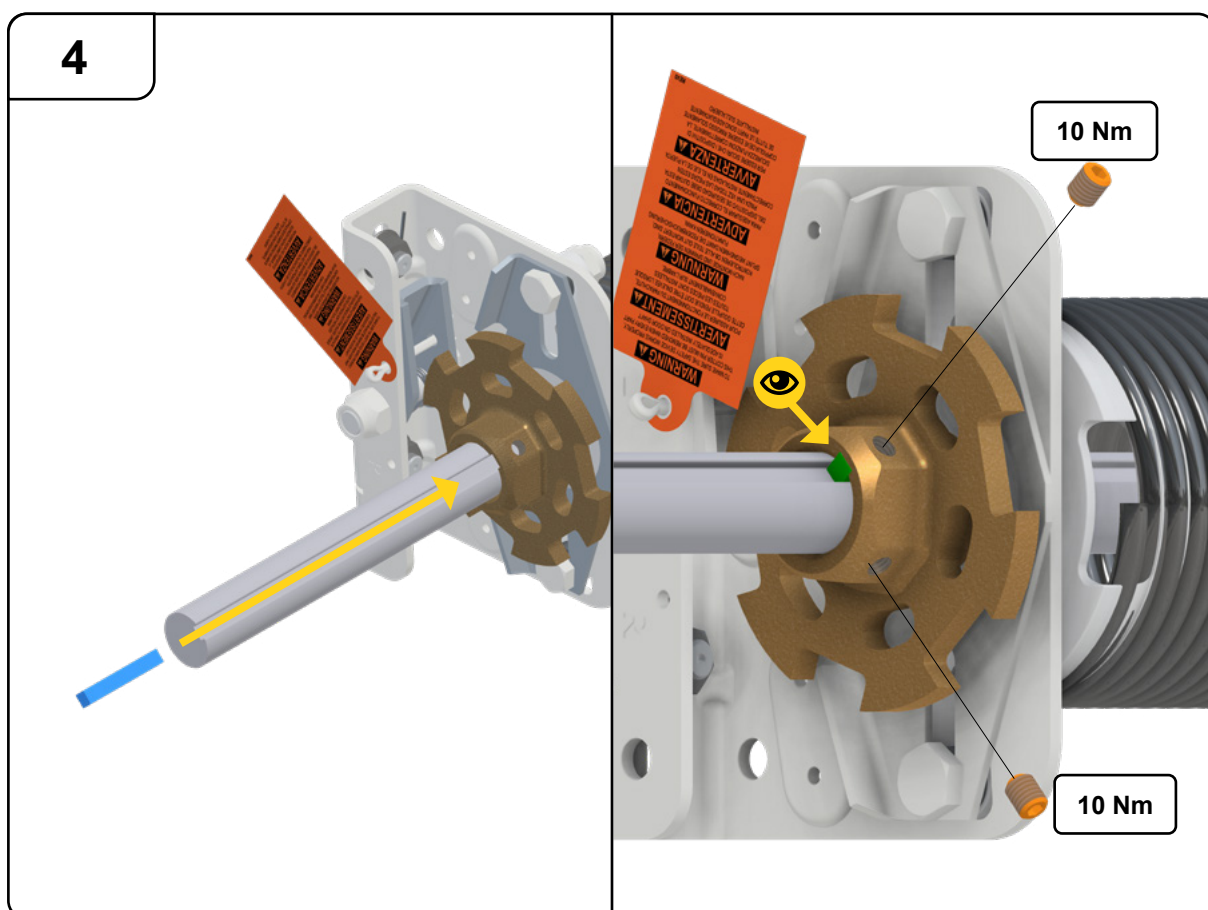
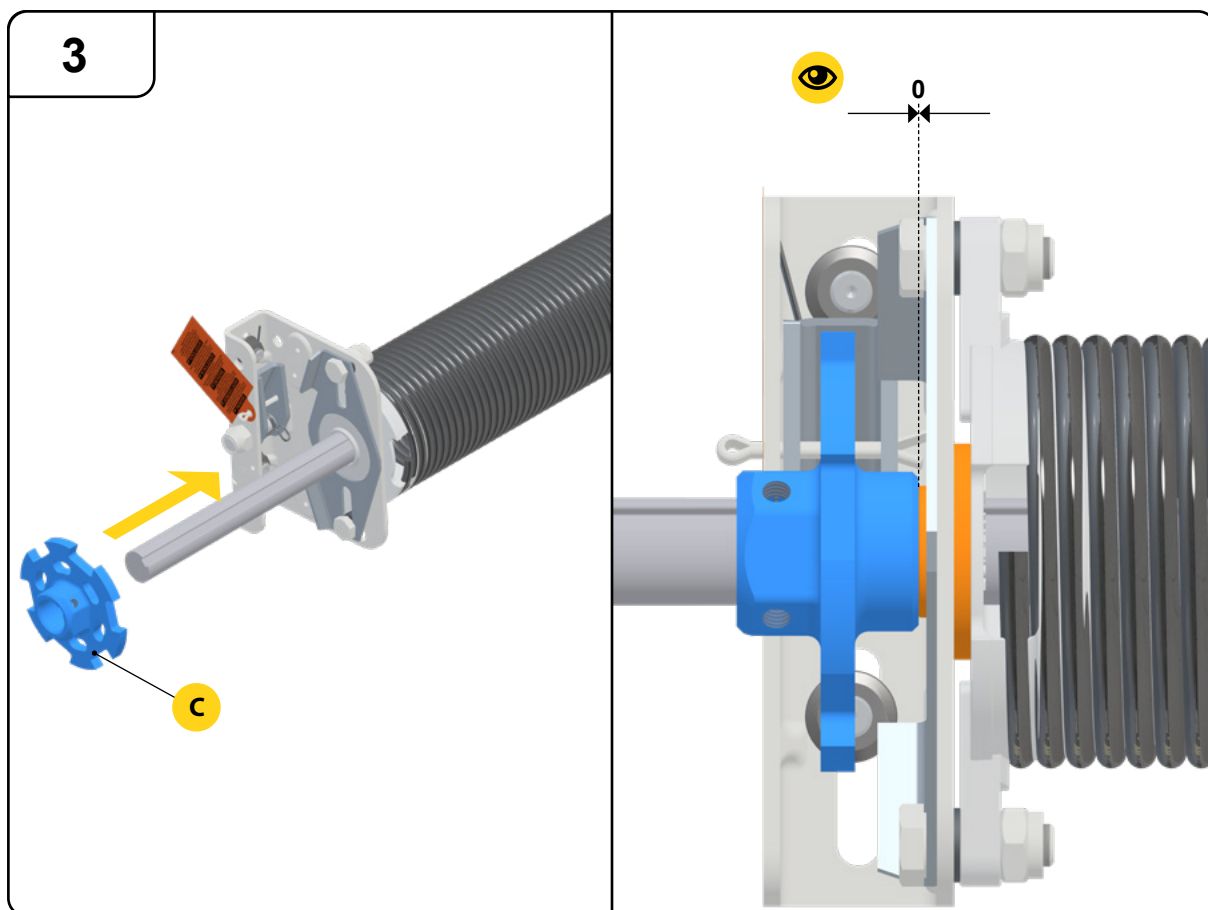

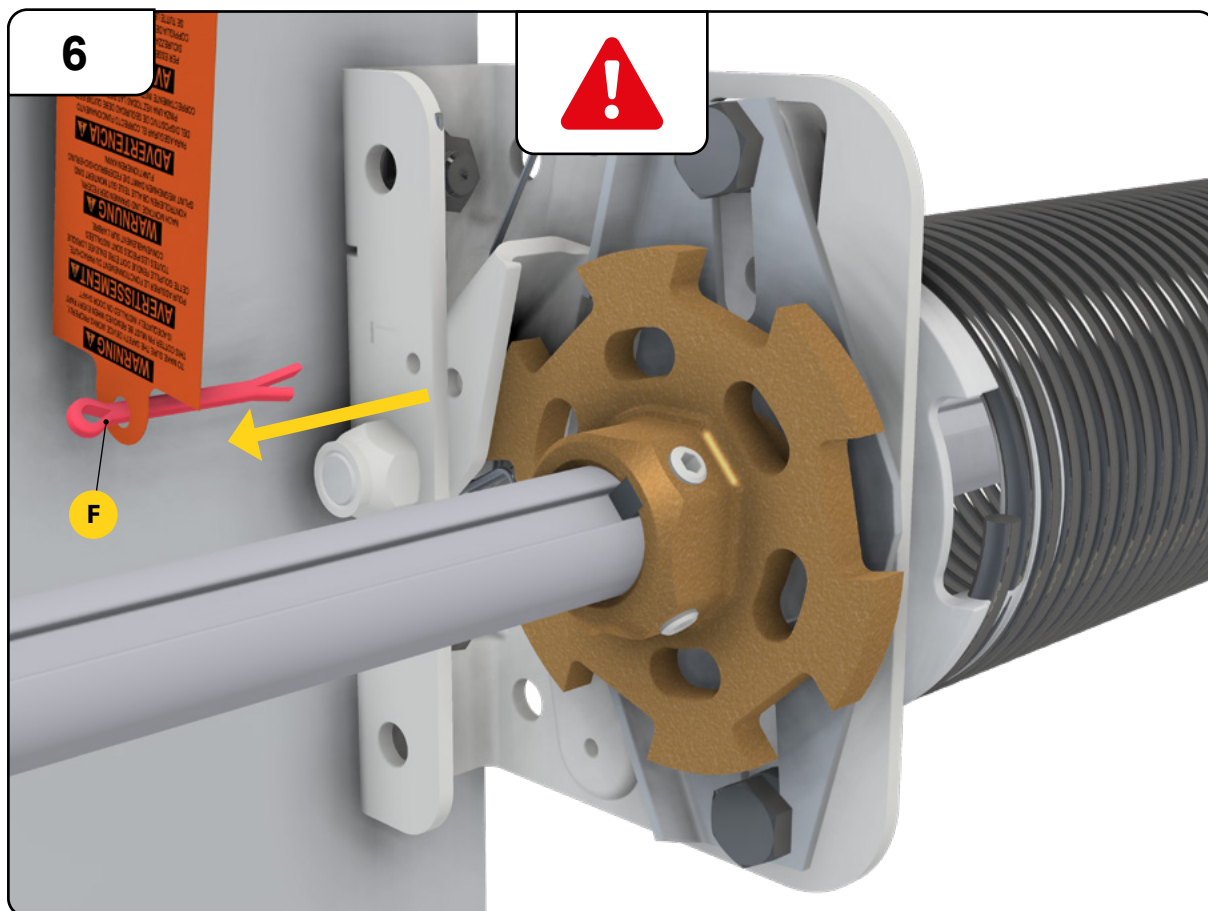
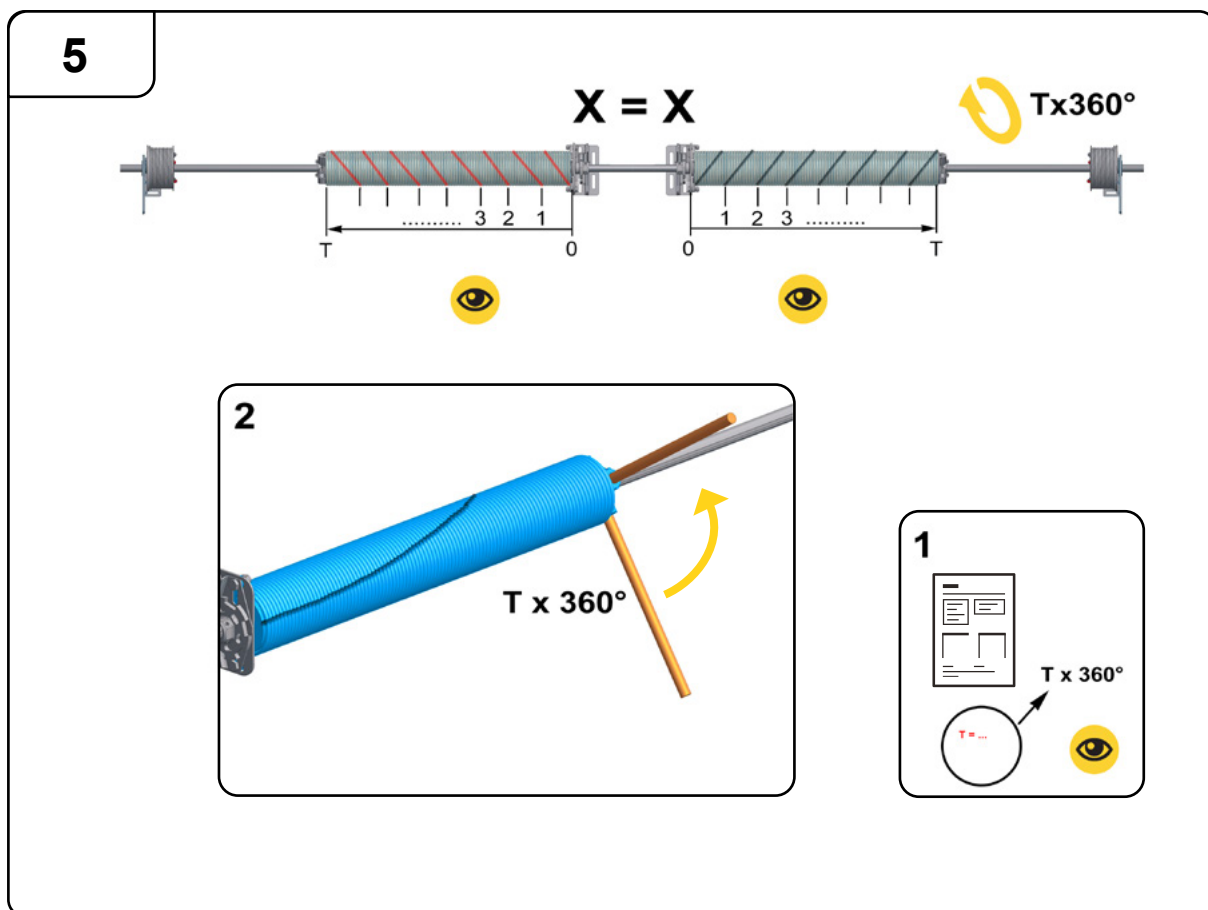

## 6. Optional extras

### 6.1. Offset plate item 25448 and 299560

L (mm)	Offset plate
86	-
111	1
127	2
152	3

Use spacer plate 25448 and 299560 to achieve the correct offset .

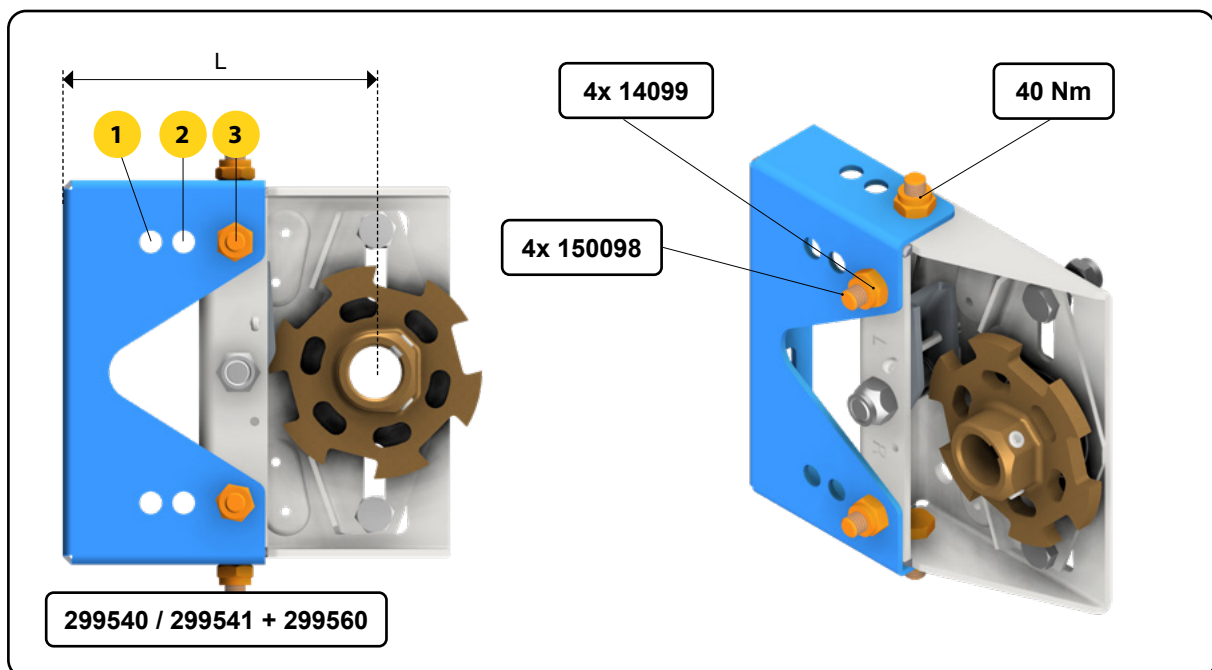
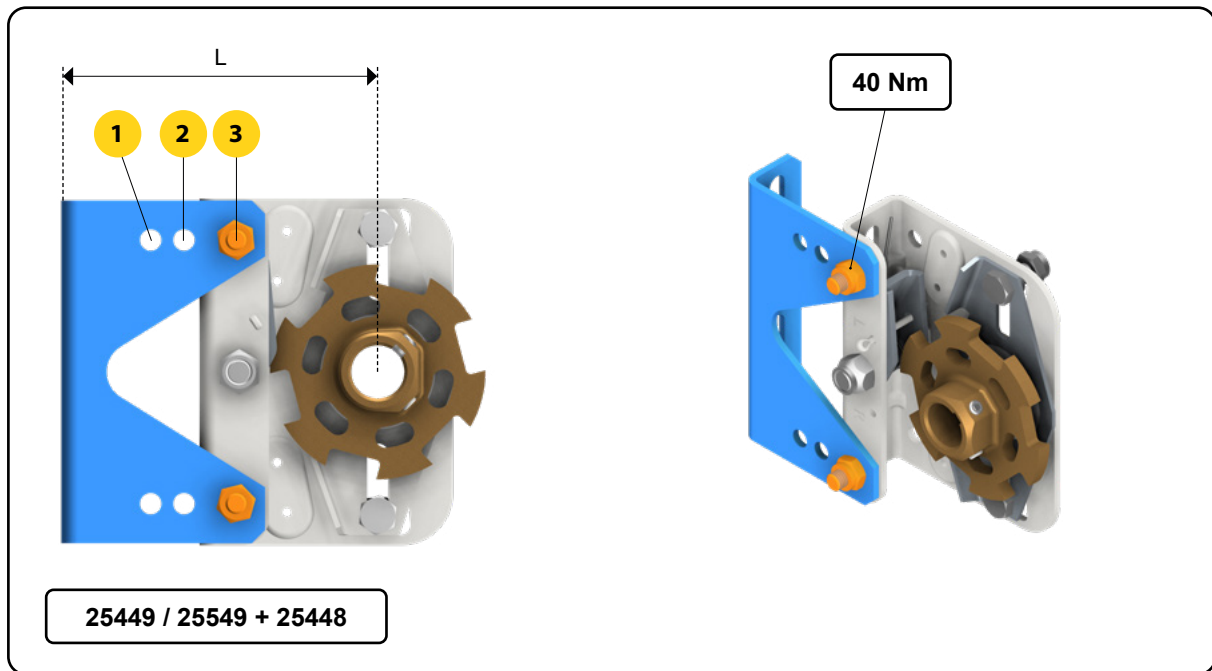





## 7. Replacing (after a broken spring)

Torsion springs and spring break protection devices may only be replaced by qualified personnel.

- Secure the door panel using struts to prevent further falling of the door panel.
- Remove the broken torsion spring with spring break protection and offset plate (if fitted).
- Fit the replacement torsion spring with spring break protection in accordance with the installation instructions.

## 8. Maintenance

This safety feature must be checked at least once a year. This check must be carried out by qualified personnel.

### Checklist:

- Remove dirt
- Check whether the force of the spring against the blocking pawl is sufficient, by depressing the blocking pawl.

If this does not return to its original position, the spring break protection should be replaced. Repeat this check five times.

- Check all bolts and nuts for tightness.

## 9. Supplier

DOCO International b.v.  
Nusterweg 96  
6130 AK Sittard (NL)  
Tel.: +31 (0)46-4200666  
Fax: +31 (0)46-4526894

## 10. Terms and conditions of supply

A copy of these terms and conditions may be requested by contacting us. We will send it free of charge.

[illegible]



## Subsidiaries

### **DOCO International B.V.**

Nusterweg 96  
6136 KV Sittard  
The Netherlands  
Phone +31 464200666  
Fax +31 464526894  
info@doco-international.com

### **DOCO International Central Europe S.R.O.**

Háj 352  
798 12 Kralice na Hané  
Czech Republic  
Phone +420 582360100  
Fax +420 582360300  
info@doco-international.com

### **DOCO International Ltd. t/a SOMMER DOCO**

Unit B3 Elvington Industrial Estate  
Elvington  
York  
YO41 4AR  
United Kingdom  
Phone +44 1904607869  
Fax +44 1904607299  
sales@doco-international.co.uk

### **DOCO SOMMER Ibérica S.L.U.**

Avenida Generalitat 55  
P.I. "Can Met Sidru"  
08530 La Garriga - Barcelona  
Spain  
Phone +34 938612825  
Fax +34 938716592  
pedidos@doco-sommer.com

## Sales Offices

### **SOMMER Automazioni s.r.l.**

Localita Le Basse 33  
38123 - Trento TN  
Italy  
Phone +39 0461263863  
Fax +39 0461269247  
italia@sommer.eu

### **SOMMER Polska Sp.z.o.o.**

Al. Jerozolimskie 439  
05 - 800 Pruszków  
Poland  
Phone +48 222302100  
biuro@sommer-polska.pl

### **SOMMER Kft.**

II. Rákóczi Ferenc út 277  
1214 Budapest  
Hungary  
Phone +36 12780261  
Fax +36 12764439  
info@sommerkft.hu

### **SOMMER Automation & Radio Co., Ltd.**

Fengrao Road 388  
201801 Shanghai, Malu County  
Jiading District, Shanghai  
China  
Phone +86 2169153919  
Fax +86 2169153155  
sales@sommer-china.com.cn

