

## 217038

Endcap left Epco 40-610mm Ral9016

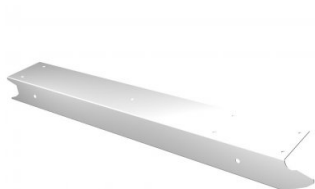

<b>Unit</b>	Piece
<b>Box</b>	40
<b>Pallet</b>	2000
<b>Weight (kg)</b>	0.47

### Product description

Zinc plated end cap for Epco panel with finger pinch safety.  
Suitable for hinges 25736, 25165 & 230105-106.

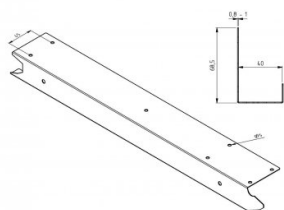

### Technical information

<b>Residential</b>	
<b>EPCO</b>	
<b>Panel height (mm)</b>	610
<b>Panel thickness (mm)</b>	40
<b>With holes</b>	
<b>Surface finish</b>	Painted
<b>RAL color</b>	RAL8017
<b>Thickness (mm)</b>	0.80 mm
<b>Position</b>	Left
<b>Material</b>	Galvanized steel
<b>Endcap Shape</b>	Epco